

版本 REV.	變更內容 MODIFICATION	日期 DATE	修改 DRAW	核準 APPROVE

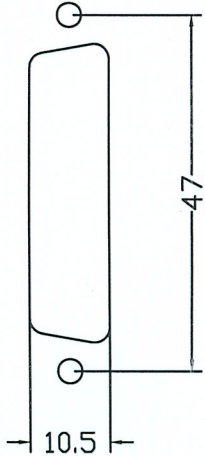
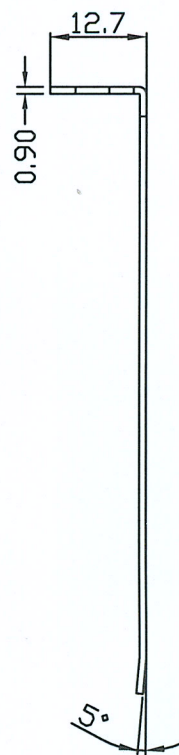
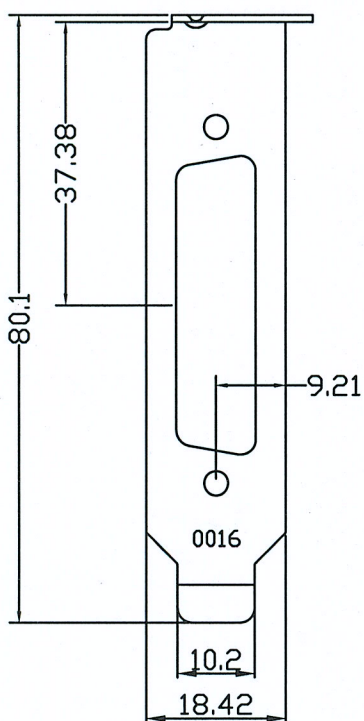
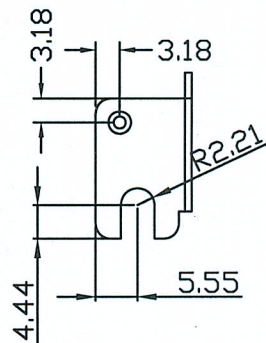

GENERAL TOLERANCE :  $\pm 0.2\text{MM}$

F	本產品不含下列物質符合RoHS&KY-RoHS-001之規定 This product does not include the following materials, accord with the stipulate of RoHS & KY-RoHS-001	$\nabla \pm 0.06$	ANGLES	單位 UNIT	mm	製圖 DRAWIN	圖號 DWG NO.	瑞朋	F
	1. 鎘 Cd, cadmium	5 多溴聯苯 PBB	$\nabla \pm 0.01$	$\nabla \pm 1^\circ$	材質 MATERIAL	SPCC T=0.9mm	設計	模號 DWG NO.	